



STERLING PRESSER
ARCHITECTS + ENGINEERS

CONTACT

STERLING PRESSER
ARCHITECTS + ENGINEERS

Lepsius Str. 42
12163 Berlin, Germany

Nicolas Sterling

T +49 (0)30 3289 5096

M +49 (0)162 2195 414

E ns@sterlingpresser.com

www.sterlingpresser.com

ELEGANCE + PERFORMANCE + SUSTAINABILITY

“ Our philosophy is that the best projects emerge from a fully integrated design approach within a unique workflow where disciplines work together to design and develop a project from the original conceptual idea.”

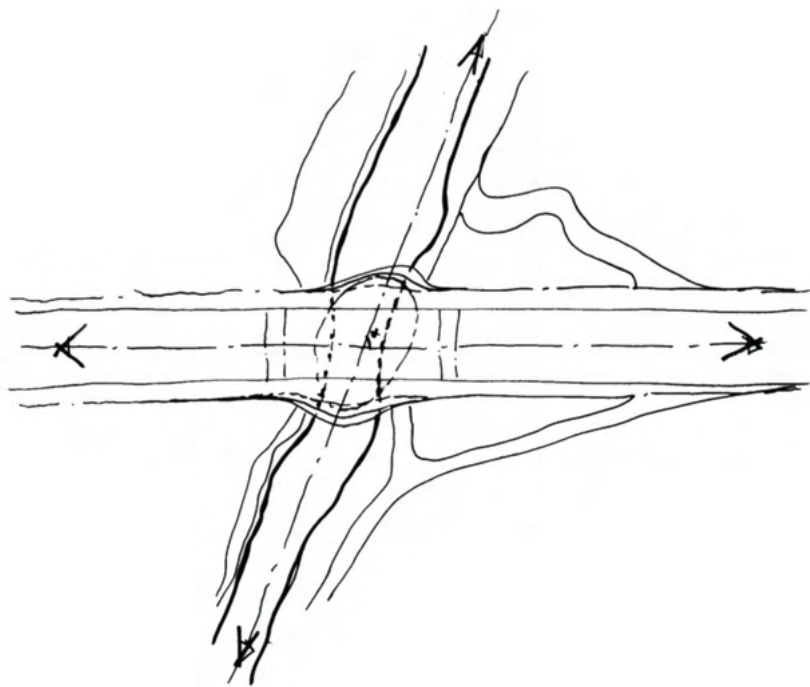

CONTENTS	3
STUDIO	7
About us	9
Services	11
PROJECTS	13
Culture and Art	14
Entertainment and Sport	15
Circular design and sustainability	16
Masterplan	17
Infrastructure and green mobility	18
Living	19
Offices	20
Interior design	21



Elegance + Performance + Sustainability

STERLING PRESSER ARCHITECTS+ENGINEERS is an international studio for architectural planning and structural concept design, based in Berlin. The founding partners combine 35 years of experience, in the respective fields of architecture and structural engineering.

The studio aims at bringing together the disciplines of architecture and engineering in order to integrate them from the beginning of the design process. It specializes in the design of emblematic architectures and structures, working together with a network of advanced engineering experts and integrating concepts of sustainability and cost control.

STERLING PRESSER ARCHITECTS+ENGINEERS designs buildings, infrastructures, master plans and interiors with the common aim to achieve a sustainable built environment. We design with the future in mind. Our team works on the questions of our time: How can we change the way we currently live, work and circulate. It has contributed to a wide range of programs from design objects and sculptures to multi-program theatres and bridges. The team is experienced to work in a variety of cultural and geographical situations and understand the impact of projects in unexpected contexts with a common goal: to achieve sustainable projects. It does explore design from the initial stage in a collaborative model, avoiding the separation of design disciplines. The design studio works flexibly in Germany, France, widely in Europe and internationally, and collaborates with other architectural and engineering firms to enable delivery from design development to construction.





Central to our ethos is the pursuit of optimal integrated design, aimed at fostering a more sustainable built environment. In an era where the social dimension of engineering and architecture is paramount, and technical proficiency in design is increasingly vital, our interdisciplinary approach forges synergies between these fields. This convergence gives rise to novel, hybrid domains, pushing the boundaries of traditional practice. At the forefront of innovation, we leverage cutting-edge 3D technologies alongside traditional methods such as sketching and storytelling. This fusion cultivates a fertile ground for cross-pollination of ideas, intuition, and creativity. By seamlessly integrating Artificial Intelligence (AI), Virtual Reality (VR) and Parametric Design into our workflow, we ensure our processes remain at the vanguard of industry standards.

At **STERLING PRESSER ARCHITECTS+ENGINEERS**, we are not just shaping structures; we are sculpting experiences, transforming spaces, and enriching communities through our unwavering commitment to excellence and innovation.





What we do

We deliver innovative, elegant and sustainable projects. We design buildings, infrastructures, masterplans, interiors and objects with the common goal: to achieve sustainable projects. We design with the future in mind. Our team works on the questions of our time: can we change the way we currently live, work and circulate. Our thorough understanding of local markets and regulatory environments enables us to deliver appropriate solutions for all client objectives and for all types of buildings.

Architectural Design

We offer comprehensive architectural design services that prioritize sustainability and adaptability. By deeply examining project briefs, we ensure our designs promote environmental improvements and address evolving needs. With a flexible team structure, we facilitate seamless project development and coordination, collaborating with various stakeholders. From initial concept to construction, we remain committed to delivering innovative solutions through rigorous architectural and design reviews.

Sustainable and Circular Design

We are committed to sustainable and circular design principles, viewing the earth as a closed system with no room for waste. We recognize the urgent need to reduce CO2 emissions outlined in global agreements like the Kyoto Protocol and Paris Agreement. By embracing regenerative construction practices, we believe cities can become carbon sinks and foster equitable development. Our approach aims not only for climate neutrality but also climate positivity, promoting new value systems and equitable societies. We advocate for a circular, long-term design approach from the project's inception, requiring collaboration across diverse supply chains to achieve.

Infrastructure Design

A Bridge is defined as a structure built to span a physical obstacle such as a body of water, valley, road, or rail without blocking the way underneath. It is constructed to provide passage over the obstacle, which is usually something that is otherwise difficult or impossible to cross. There are many unique designs of bridges, each serving a particular purpose and applicable to different situations.



Culture and Art

We specialize in vital cultural projects, ensuring buildings appeal to current demographics and remain adaptable for future generations through expertise in new developments and refurbishments.

Entertainment and sport

Innovative spaces crafted for dynamic events, blending functionality with aesthetics to create immersive experiences for spectators and performers alike.

Circular design and sustainability

We prioritize sustainability in building design, aiming to minimize CO² emissions and energy usage. By leveraging green technologies, we create healthy, inspiring spaces that are cost-effective and environmentally balanced.

Masterplan

Holistic urban blueprints integrating architecture, landscape, and infrastructure to create vibrant, sustainable communities that evolve with the needs of society.

Infrastructure and green mobility

A key requirement in creating the infrastructure of the future will be to ensure that projects are delivered at a scale and speed never achieved before, while also adapting to changing climates and environments.

Living

As communities grow, new approaches are needed for providing safe, attractive, harmonious and sustainable environments that nurture a common sense of belonging.

Offices

We design offices with a focus on user needs and sustainability. By integrating architecture, structure, and services design, we create superior commercial buildings that are cost-effective to operate.

Interior design

Thoughtfully curated spaces that harmonize functionality and aesthetics, enhancing the human experience within built environments through creative use of materials, lighting, and spatial arrangement.

Culture and Art

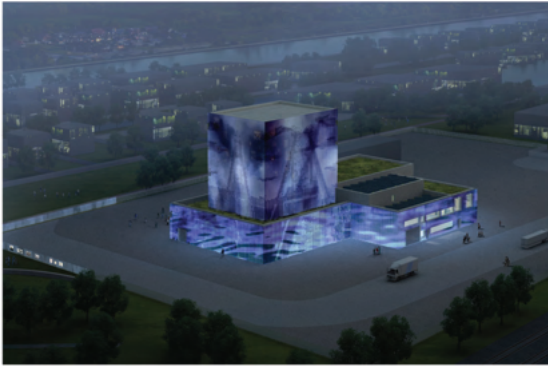

Aus der Tiefe in die Höhe, Bergkamen, Germany (2022) - 2nd Prize
 Client: City Bergkamen
 Typology: Geothermal station - Landmark
 Size M2: 2.430 building footprint
 Status: Design



Tartu Downtown Cultural Centre, Tartu, Estonia (2023)
 Client: Tartu City
 Typology: Cultural Centre
 Size M2: 26.000
 Status: Design



Outdoor Water Theatre Park, Taiyuan, China (2018 - 2020)
 Client: Qianyuan Kultur Kommunikation LTD
 Typology: Outdoor Theatre - 3.500 seats / Landscape Design / Masterplan
 Size M2 : 8.900
 Status: Built

Entertainment and sport



WH Arena, Vienna, Austria (2020) - Final Stage Competition
 Client: Wien Holding
 Typology: Arena - 20.000 seats
 Size M2 : 42.400
 Status: Design



Arena - Arena Park, Vienna, Austria (2021)
 Client: Magistrat der Stadt Wien
 Typology: Arena - 3.000 seats
 Size M2 : 18.000
 Status: Design



Jahnsportpark - Stadion, Berlin, Germany (2022) - Final Stage Competition
 Client: Senatsverwaltung Berlin
 Typology: Arena - 20.000 seats
 Size M2 : 54.000
 Status: Design



Circular design and sustainability



Quartertower - Timbertower, Augsburg, Germany (2018)
 Client: Millenium Building Quartertower GmbH
 Typology: Living Spaces and Offices
 Size M2: 3.600
 Status: Design



Highrise Building Tartu MNT 17, Tallinn, Estonia (2023)
 Client: Elon OÜ
 Typology: High Rise Building
 Size M2: 22.800
 Status: Design



Bamiyan Cultural Centre, Bamiyan, Afghanistan (2015)
 Client: Unesco
 Typology: Cultural Centre
 Size M2: 1.900
 Status: Idea



Wabi Sabi Hotel, Porto, Portugal (2021)
 Client: Villa eugénie
 Typology: Hotel
 Size M2: 1.800
 Status: Design



Ostbahnhof, Berlin, Germany (2021)
 Client: HB Reavis
 Typology: Modular Design - Office
 Size M2: 25.000
 Status: Concept



Interactive Museum, Si Fang, China (2022)
 Client: SOL
 Typology: Warehouse Conversion
 Size M2: 10.078
 Status: Design

Masterplan



Masterplan, Luosanling, China (2020) - Phase 2
 Client: SOL
 Typology: Masterplan
 Size M2: 420.000
 Status: Design



Zhejiang Sci-Tech University, Zhejiang, China (2017)
 Client: Zhejiang Sci-Tech University
 Typology: Campus
 Size M2: 15.000
 Status: Design



Plot 9 Eco Village Masterplan, Taiyuan Park, China (2018 - Ongoing)
 Client: Qianyuan Kultur Kommunikation LTD
 Typology: Eco village
 Size M2: 18.000
 Status: Design



E - Car Smart City, Wenzhou, China (2022)
 Client: SOL
 Typology: Offices, entertainment, retail / masterplan
 Size M2: 70.240
 Status: Design

Infrastructure and green mobility



Taiyuan Park Bridge, Taiyuan, China (2019 - 2020)
Client: Qianyuan Kultur Kommunikation LTD
Typology: Entrance Footbridge - New Theatre
Maximum Span 31m, Length 200m, Width 6.5m
Status: Built



Requalification Pont du Lion, Saint G  nis, France (2019 - 2022)
Client: Saint G  nis City
Typology: Widening Existing Bridge - Revalorisation
Span 18m, Width 16m
Status: Built



Taiyuan Plot 9 Bridge, Taiyuan, China (2019 - 2020) - Shortlisted
Client: Qianyuan Kultur Kommunikation LTD
Typology: Plot 9 Masterplan Footbridge
Maximum Span 28m, Length 120m, Width 4.5m
Status: Design



Requalification Pont du Lion, Saint G  nis, France (2019 - 2022)
Client: Saint G  nis City
Typology: Widening Existing Bridge Revalorisation
Span 18m, Width 16m
Status: Built

Living



Wabi Sabi Hotel, Porto, Portugal (2021)
Client: Villa Eug  nie
Typology: Hotel apartments
Size M2: 1.800
Status: Concept



B31 Residence, Berlin, Germany (2022)
Client: Weishaupt
Typology: Residential
Size M2 : 1.000
Status: Design



Plot 9 Entrance Tower Building, Taiyuan Park, China (2020)
Client: Qianyuan Kultur Kommunikation LTD
Typology: Library, Cafe, Information Centre
Size M2 : 8.000
Status: Design



Offices



Ostbahnhof, Berlin, Germany (2021)
Client: HB Reavis
Typology: Office - Modular Design
Size M2 : 25.000
Status: Concept



Wenling towers, Wenling, China (2018)
Client: SOL
Typology: High Rise
Size M2 : 10.000
Status: Design



Longquan towers, Longquan, China (2018)
Client: SOL
Typology: High Rise
Size M2 : 8.000
Status: Design



Mixed Use Building, Taiyuan Park, China (2020)
Client: Qianyuan Kultur Kommunikation LTD
Typology: Library, Cafe, Information Centre, Offices
Size M2 : 5.000
Status: Built



Interior design



Palacio Hotel, Madrid, Spain (2020)
Client: Barcelo
Typology: Hotel
Size M2 : 950
Status: Concept



Wabi Sabi Hotel, Porto, Portugal (2021)
Client: Villa eugénie
Typology: Hotel appartments
Size M2 : 1.800
Status: Concept



The Amper Hotel, Salzburg, Austria (2021)
Client: Private
Typology: Residential
Size M2 : 425
Status: Idea



NH House, Geneva, Switzerland (2022)
Client: NH Company
Typology: Private appartments
Size M2 : 680
Status: Idea

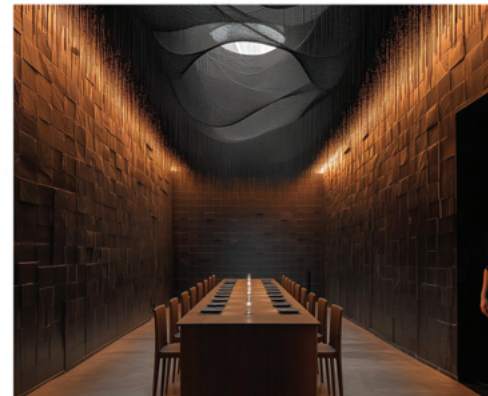

Le Ciel, Paris, France (2020)
Client: NR
Typology: Hotel
Size M2 : 6.500
Status: Concept



STERLING PRESSER
ARCHITECTS+ENGINEERS

